

# TEAC

## OWNER'S MANUAL

# UR-Stream

## 4K/UHD VIDEO STREAMER/RECORDER

Thank you for choosing TEAC.  
Read this manual carefully to get the best performance from this unit.  
After reading this manual, keep it in a safe place for future reference.

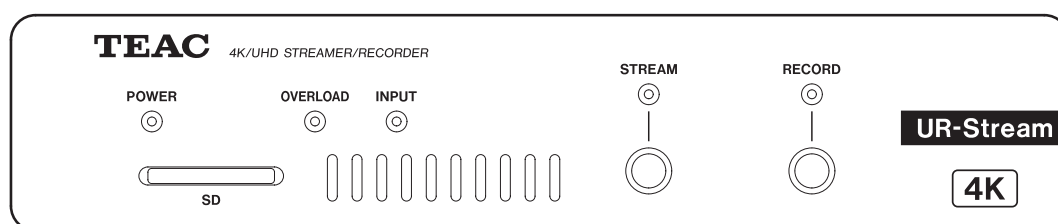

# IMPORTANT SAFETY INSTRUCTIONS

**WARNING: TO PREVENT FIRE OR SHOCK HAZARD, DO NOT EXPOSE THIS APPLIANCE TO RAIN OR MOISTURE.**

## For U.S.A.

### Declaration of Conformity

Model Number: VS-R264 / VS-R265

Trade Name: TASCAM

Responsible party: TEAC AMERICA, INC.

Address: 10410 Pioneer Blvd. Suite #1 Santa Fe Springs, California 90670, U.S.A.

Telephone number: 1-323-726-0303



This device complies with Part 15 of the FCC Rules. Operation is subject to the following two conditions: (1) this device may not cause harmful interference, and (2) this device must accept any interference received, including interference that may cause undesired operation.

### INFORMATION TO THE USER

This equipment has been tested and found to comply with the limits for a Class B digital device, pursuant to Part 15 of the FCC Rules. These limits are designed to provide reasonable protection against harmful interference in a residential installation.

This equipment generates, uses, and can radiate radio frequency energy and, if not installed and used in accordance with the instruction manual, may cause harmful interference to radio communications. However, there is no guarantee that interference will not occur in a particular installation.

If this equipment does cause harmful interference to radio or television reception, which can be determined by turning the equipment off and on, the user is encouraged to try to correct the interference by one or more of the following measures.

- Reorient or relocate the receiving antenna.
- Increase the separation between the equipment and receiver.
- Connect the equipment into an outlet on a circuit different from that to which the receiver is connected.
- Consult the dealer or an experienced radio/TV technician for help.

### CAUTION

Changes or modifications to this equipment not expressly approved by TEAC CORPORATION for compliance could void the user's authority to operate this equipment.

## For Canada

THIS CLASS B DIGITAL APPARATUS COMPLIES WITH CANADIAN ICES-003.

CET APPAREIL NUMERIQUE DE LA CLASSE B EST CONFORME A LA NORME NMB-003 DU CANADA.



This product complies with the European Directives request and the other Commission Regulations.

- Read these instructions.
- Keep these instructions.
- Heed all warnings.
- Follow all instructions.
- Do not use this apparatus near water.
- Clean only with dry cloth.
- Do not block any ventilation openings. Install in accordance with the manufacturer's instructions.
- Do not install near any heat sources such as radiators, heat registers, stoves, or other apparatus (including amplifiers) that produce heat.
- Do not defeat the safety purpose of the polarized or grounding-type plug. A polarized plug has two blades with one wider than the other. A grounding type plug has two blades and a third grounding prong. The wide blade or the third prong are provided for your safety. If the provided plug does not fit into your outlet, consult an electrician for replacement of the obsolete outlet.
- Protect the power cord from being walked on or pinched particularly at plugs, convenience receptacles, and the point where they exit from the apparatus.
- Only use attachments/accessories specified by the manufacturer.
- Use only with the cart, stand, tripod, bracket, or table specified by the manufacturer, or sold with the apparatus. When a cart is used, use caution when moving the cart/apparatus combination to avoid injury from tip-over.



- Unplug this apparatus during lightning storms or when unused for long periods of time.
  - Refer all servicing to qualified service personnel. Servicing is required when the apparatus has been damaged in any way, such as power-supply cord or plug is damaged, liquid has been spilled or objects have fallen into the apparatus, the apparatus has been exposed to rain or moisture, does not operate normally, or has been dropped.
- The apparatus draws nominal non-operating power from the AC outlet with its POWER or STANDBY/ON switch not in the ON position.
  - The mains plug is used as the disconnect device, the disconnect device shall remain readily operable.
  - Caution should be taken when using earphones or headphones with the product because excessive sound pressure (volume) from earphones or headphones can cause hearing loss.
  - If you are experiencing problems with this product, contact TEAC for a service referral. Do not use the product until it has been repaired.

## CAUTION

- Do not expose this apparatus to drips or splashes.
- Do not place any objects filled with liquids, such as vases, on the apparatus.
- Do not install this apparatus in a confined space such as a book case or similar unit.
- The apparatus should be located close enough to the AC outlet so that you can easily grasp the power cord plug at any time.
- If the product uses batteries (including a battery pack or installed batteries), they should not be exposed to sunshine, fire or excessive heat.
- CAUTION for products that use replaceable lithium batteries: there is danger of explosion if a battery is replaced with an incorrect type of battery. Replace only with the same or equivalent type.

## For European Customers

### Disposal of electrical and electronic equipment

- All electrical and electronic equipment should be disposed of separately from the municipal waste stream via collection facilities designated by the government or local authorities.
- By disposing of electrical and electronic equipment correctly, you will help save valuable resources and prevent any potential negative effects on human health and the environment.
- Improper disposal of waste electrical and electronic equipment can have serious effects on the environment and human health because of the presence of hazardous substances in the equipment.

- The Waste Electrical and Electronic Equipment (WEEE) symbol, which shows a wheeled bin that has been crossed out, indicates that electrical and electronic equipment must be collected and disposed of separately from household waste.
 

If a battery or accumulator contains more than the specified values of lead (Pb), mercury (Hg), and/or cadmium (Cd) as defined in the Battery Directive (2006/66/EC, 2013/56/EU), then the chemical symbols for those elements will be indicated beneath the WEEE symbol.



- Return and collection systems are available to end users. For more detailed information about the disposal of old electrical and electronic equipment, please contact your city office, waste disposal service or the shop where you purchased the equipment.

## CAUTION

- DO NOT REMOVE THE EXTERNAL CASES OR CABINETS TO EXPOSE THE ELECTRONICS. NO USER SERVICEABLE PARTS ARE INSIDE.
- IF YOU ARE EXPERIENCING PROBLEMS WITH THIS PRODUCT, CONTACT THE STORE WHERE YOU PURCHASED THE UNIT FOR A SERVICE REFERRAL. DO NOT USE THE PRODUCT UNTIL IT HAS BEEN REPAIRED.
- USE OF CONTROLS OR ADJUSTMENTS OR PERFORMANCE OF PROCEDURES OTHER THAN THOSE SPECIFIED HEREIN MAY RESULT IN HAZARDOUS RADIATION EXPOSURE

The nameplate is located on the bottom of the unit as shown below.

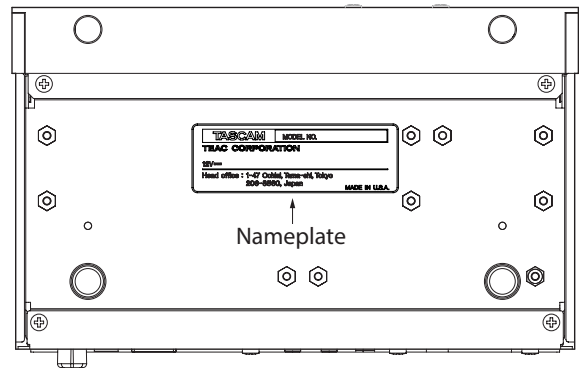
Front side



---

## Contents

---

Trademarks.....	4
Introduction.....	4
Included items.....	4
System requirements.....	4
Supported web browser.....	4
Conventions used in this manual.....	5
Note about the Reference Manual.....	5
Precautions for placement and use.....	5
Beware of condensation.....	5
Cleaning the unit.....	5
Setup procedure.....	6
Specifications.....	7
Video inputs and outputs.....	7
Audio inputs and outputs.....	7
Control input/output.....	7
Audio performance.....	7
Other.....	7

---

## Trademarks

---

- TASCAM is a registered trademark of TEAC Corporation.
- The terms HDMI and HDMI High-Definition Multimedia Interface, and the HDMI Logo are trademarks or registered trademarks of HDMI Licensing LLC in United States and other countries.
- The SDHC logo is a trademark of SD-3C, LLC.



- Microsoft, Windows and Windows Vista are either registered trademarks or trademarks of Microsoft Corporation in the United States and/or other countries.
- Apple, Mac, macOS, iPad, Lightning, App Store and iTunes are trademarks of Apple Inc.
- Google Chrome are trademarks of Google Inc.
- Other company names, product names and logos in this document are the trademarks or registered trademarks of their respective owners.

---

## Introduction

---

Thank you very much for purchasing a UR-Stream 4K/UHD VIDEO STREAMER/RECORDER.

Before connecting and using this unit, please take time to read this manual thoroughly to ensure you understand how to properly set it up and connect it, as well as how to use its many useful and convenient functions. After you have finished reading this manual, please keep it in a safe place for future reference.

You can also download this Owner's Manual from the TEAC Global Site (<http://teac-global.com/>).

**UR-Stream is not a medical grade device. Installation and use of UR-Stream in a healthcare or medical facility such as hospital are the responsibility of the installer. TEAC is not liable for any troubles and/or issues which may be caused by use of a non-medical grade device in that facility.**

---

## Included items

---

This product includes the following items.

Take care when opening the package to avoid damaging the items. Keep the box and packing materials for transportation in the future.

Please contact the store where you purchased this unit if any of these items are missing or have been damaged during transportation.

- Main unit .....× 1
- USB flash drive.....× 1
  - TASCAM DISCOVERY application
  - Reference Manual
- Installation brackets .....× 2
- Euroblock plug .....× 4
- Cable band kit .....× 1
- Owner's Manual (this document) .....× 1

---

## System requirements

---

Check the TEAC Global Site (<http://teac-global.com/>) for the latest information about supported operating systems.

---

## Supported web browser

---

Google Chrome version 39 or newer

---

## Conventions used in this manual

---

In this manual, we use the following conventions:

- SD/SDHC memory cards are called “SD cards”.
- “USB flash drives” are sometimes called “USB drives”.
- As necessary, additional information is provided under TIP, NOTE and CAUTION headings.

### TIP

These are tips about how to use the unit.

### NOTE

These provide additional explanations and describe special cases.

### ATTENTION

Failure to follow these instructions could result in damage to equipment or lost data, for example.

### CAUTION

Failure to follow these instructions could result in injury.

---

## Note about the Reference Manual

---

This Owner’s Manual explains each of the functions of this unit. Please see the Reference Manual for detailed information about each of the functions.

The Reference Manual can be downloaded from the included USB flash drive and the TEAC Global Site (<http://teac-global.com/>).

---

## Precautions for placement and use

---

- The operating temperature range of this unit is 0–40 °C.
- Do not install this unit in the following types of locations. Doing so could make the sound quality worse or cause malfunction.
  - Places with significant vibrations
  - Next to a window or in another location exposed to direct sunlight
  - Near heaters or other extremely hot places
  - Extremely cold places
  - Very humid or poorly ventilated places
  - Very dusty places
- To enable good heat dissipation, do not place anything on top of the unit.
- Do not place this unit on top of a power amplifier or other device that generates heat.
- When installing this unit on or under a desk, use the included attachment brackets.

---

## Beware of condensation

---

Condensation could occur if the unit is moved from a cold place to a warm place, it is used immediately after a cold room has been heated or it is otherwise exposed to a sudden temperature change.

To prevent this, or if this occurs, let the unit sit for one or two hours at the new room temperature before using it.

---

## Cleaning the unit

---

Use a dry soft cloth to wipe the unit clean. Do not wipe with chemical cleaning cloths, thinner, alcohol or other chemical agents. Doing so could damage the surface or cause discoloration.

## Setup procedure

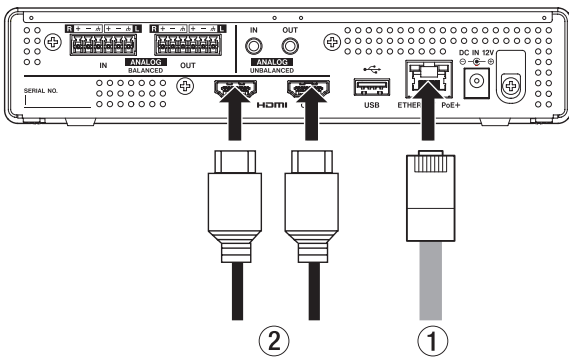

- Using a category 5E or higher LAN cable (①) connect the UR-Stream to a switching hub that supports PoE Plus power supply.

### NOTE

To connect to a switching hub that does not support PoE Plus power supply, use a dedicated PS-P1220E AC adapter (sold separately) to supply power.

Use the AC adapter (TASCAM PS-P1220E) to connect a power supply to the unit as shown below.

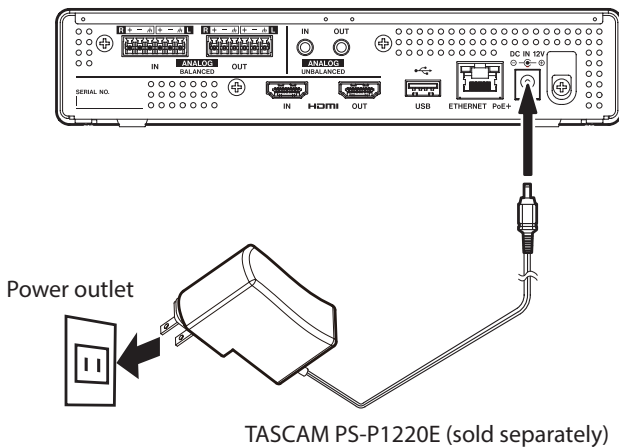

- Connect HDMI devices to the HDMI IN/OUT connectors (②).

#### To encode:

Connect a camera or other video source to the HDMI IN connector.

When the video source becomes active, the INPUT indicator on the front of the unit lights.

#### To decode:

Connect a video monitor or TV to the HDMI OUT connector.

- Connect the included USB flash drive to a computer connected to the network and open the "Setup" folder.
- Select the file for the operating system being used and install TASCAM DISCOVERY.
- Launch TASCAM DISCOVERY.
- Click "Open" for the UR-Stream that you want to log into and launch the "Streaming Dashboard".
- Click the tab area screen selection buttons to open the encoder or decoder settings screen.

#### To encode:

- Click "Encoder Control" to open the Encoder Control screen.
- Click the Output Settings [Configure](#) button on the Encoder Control screen to open the encoder output screen.
- Select the tab for the desired streaming type.

#### To decode:

- Click "Decoder Control" to open the Decoder Control screen.
- Click the Stream Settings [Configure](#) button on the Decoder Control screen to open the Decoder Stream Settings screen.
- Select the tab for the desired streaming type. Specifications

# Specifications

---

## Video inputs and outputs

### HDMI IN/OUT ports

Connector: Type A receptacle

### Input resolutions

2160p30/p29.97/p25/p24/p23.98,  
1080p60/p59.94/p50/p30/p29.97/  
p25/p24/p23.98, 720p60/p59.94/p50,  
576p50, 480p60, 480p59.94

### Frame rate limiting

On/Off

### Encode scaling resolution

Passthrough, 320x180p, 480x270p,  
640x360p, 720x480p, 720x576p,  
960x540p, 1280x720p, 1920x1080p,  
3840x2160p

### Encoding formats

H.264, H.265

### Encoding bit rates

500 kbps - 30 Mbps

### Bit rate control

Variable, Constant

### Key frame interval

Seconds: 0.25 - 16.5 (default: 1) in 0.25  
intervals

Frames: 3 - 1000

### Video streaming

Supported protocols\*: RTMP, RTSP, HLS,  
RTP, UDP

\* H.265 format streaming only  
supports RTP and UDP.

---

## Audio inputs and outputs

### ANALOG IN connectors (balanced)

Connectors: Euroblock 3.81mm pitch

Nominal input levels:

+4 dBu (1.23 Vrms, when Ref.Level set  
to other than -9 dBFS)

+6 dBu (1.55 Vrms, when Ref. Level  
set to -9 dBFS)

Maximum input level (switchable):

+15 dBu (4.36 Vrms, Ref. Level: -9  
dBFS)

+18 dBu (6.16 Vrms, Ref. Level: -14  
dBFS)

+20 dBu (7.75 Vrms, Ref. Level: -16  
dBFS)

Input impedance: 10 k $\Omega$  or higher

### ANALOG IN connectors (unbalanced)

Connector: 3.5mm (1/8") stereo mini jack

Input impedance: 10 k $\Omega$

Minimum input level: -10 dBV (0.316  
Vrms)

Maximum input level: +6 dBV (2.0  
Vrms)

### ANALOG OUT connectors (balanced)

Connectors: Euroblock 3.81mm pitch

Nominal output levels:

+4 dBu (1.23 Vrms, when Ref.Level set  
to other than -9 dBFS)

+6 dBu (1.55 Vrms, when Ref. Level  
set to -9 dBFS)

Maximum output level (switchable):

+15 dBu (4.36 Vrms, Ref.Level: -9  
dBFS)

+18 dBu (6.16 Vrms, Ref.Level: -14  
dBFS)

+20 dBu (7.75 Vrms, Ref.Level: -16  
dBFS)

Output impedance: 200  $\Omega$  or lower

### ANALOG OUT connectors (unbalanced)

Connector: 3.5mm (1/8") stereo mini  
jack

Output impedance: 200  $\Omega$

Minimum output level: -10 dBV (0.316  
Vrms)

Maximum output level: +6 dBV (2.0  
Vrms)

- 0 dBu=0.775 Vrms

---

## Control input/output

### Ethernet/PoE+ connector

Connector: RJ-45

Transmission protocol: TCP/IP, UDP, HTTP

Gigabit Ethernet standard: 1000BASE-T  
(IEEE 802.3ab)

Cables: category 5e or faster STP cables

### USB port

Connector: USB A-type 4-pin

Protocol: USB 3.0

---

## Audio performance

### Built-in AD converter performance

#### Distortion (THD+N)

0.002%

#### S/N ratio

102dB

### Built-in DA converter performance

#### Distortion (THD+N)

0.00035%

#### S/N ratio

130dB

### Analog input - digital (HDMI) output performance (AAC encoding/decoding 512 kbps)

#### Frequency response

20 Hz - 16.5 kHz:  $\pm$ 0.5 dB (JEITA)

#### Distortion (THD+N)

0.008% or less (Full scale -0.5 dB, JEITA)

#### S/N ratio

94 dB or higher (JEITA)

#### Dynamic range

95 dB or higher (JEITA)

#### Channel crosstalk

90 dB or higher (JEITA)

### Digital (HDMI) - analog output performance (AAC encoding/decoding 512 kbps)

#### Frequency response

20 Hz - 16.5 kHz:  $\pm$ 0.5 dB (JEITA)

#### Distortion (THD+N)

0.007% or less (Full scale -0.5 dB, JEITA)

#### S/N ratio

Balanced output: 113 dB or higher  
(JEITA)

Unbalanced output: 109 dB or higher  
(JEITA)

#### Dynamic range

96 dB or higher (JEITA)

#### Channel crosstalk

100 dB or higher (JEITA)

Note: JEITA indicates compliance with  
JEITA CP-2150

---

## Other

### Power

PoE Plus Class 4

TASCAM PS-P1220E AC adapter (sold  
separately)

### Power consumption

12.2W

### Dimensions

214 x 44.5 x 136.1mm (W x H x D,  
including protrusions)

### Weight

850g

### Operating temperature range

0 - 40°C (32 - 104°C)

# TEAC

---

TEAC CORPORATION 1-47 Ochiai, Tama-shi, Tokyo 206-8530 Japan Phone: +81-42-356-9160

---

TEAC AMERICA, INC. 10410 Pioneer Blvd. Suite #1, Santa Fe Springs, California 90670, U.S.A. Phone: +1-323-726-0303

---

TEAC EUROPE GmbH. Bahnstrasse 12, 65205 Wiesbaden-Erbenheim, Germany Phone:+49-611-7158-0

---